



WHAT IS ?

A new and improved Easytrip **Customer Account Management System**. It is your all in-one web application for your Easytrip RFID account; where you can modify your account details, generate and download statement of account, check your transactions, reload your RFID, and a lot more!

myeasytripcams.easytrip.ph

SYSTEM REQUIREMENTS

For Desktop:

☒ You should have Internet or Intranet to access the **myeasytrip** web application.

Note: The speed of web application depends on the network, web application server and your hardware specifications.

☒ You should use minimum of MS Windows 2010 and on any HTML5 browser-based client except Internet Explorer, Opera and Microsoft Edge.

☒ The User Interface is designed for a user-friendly and intuitive approach.

For Mobile/Tablet:

☒ You should have Internet or Intranet to access the **myeasytrip** web application. The speed of the access depends on the WIFI or cellular data network and gadget hardware specification.

☒ For iOS - You should use Safari bundled with iOS 9 and above releases but only on stock iOS without jailbreaking. Apple TV is not supported

☒ For Android - You should use Google Chrome with Android 4.4 and above but only on stock Android OSs without modification and aftermarket modification. Only phones and tablets are supported. No Android TV and other embedded Android devices.

REGISTRATION PROCESS

- Go to myeasytripcams.easytrip.ph and click the "Register" button.
- Fill up the fields with the following details below:
 - Account Number
 - First Name
 - Last Name
 - Email Address

Note: You must input the encoded details of your Easytrip RFID account

 - Desired Username – It should be a unique username
 - Security Questions
 - Password - it should consist of not less than 8 characters, comprising a mixture of alpha/numeric characters, hence ensuring it is not a single word that would appear in dictionary. The system will disallow easy to guess passwords (e.g. 111111, AAAAAA)
- After you filled up the required fields, click the "Create Account" button then the validation of data will be started.

Once the registration is successful, you will receive a confirmation email that will expire within 15 minutes. You need to confirm your registration so that the system will activate your user account.

LOGIN PROCESS

- Enter the username - entry will only be recognized by the system if your user account has been activated.
- Enter the password - entry can only be visible if the eye icon has been clicked to assure that the access is correct.
- Click the Login button

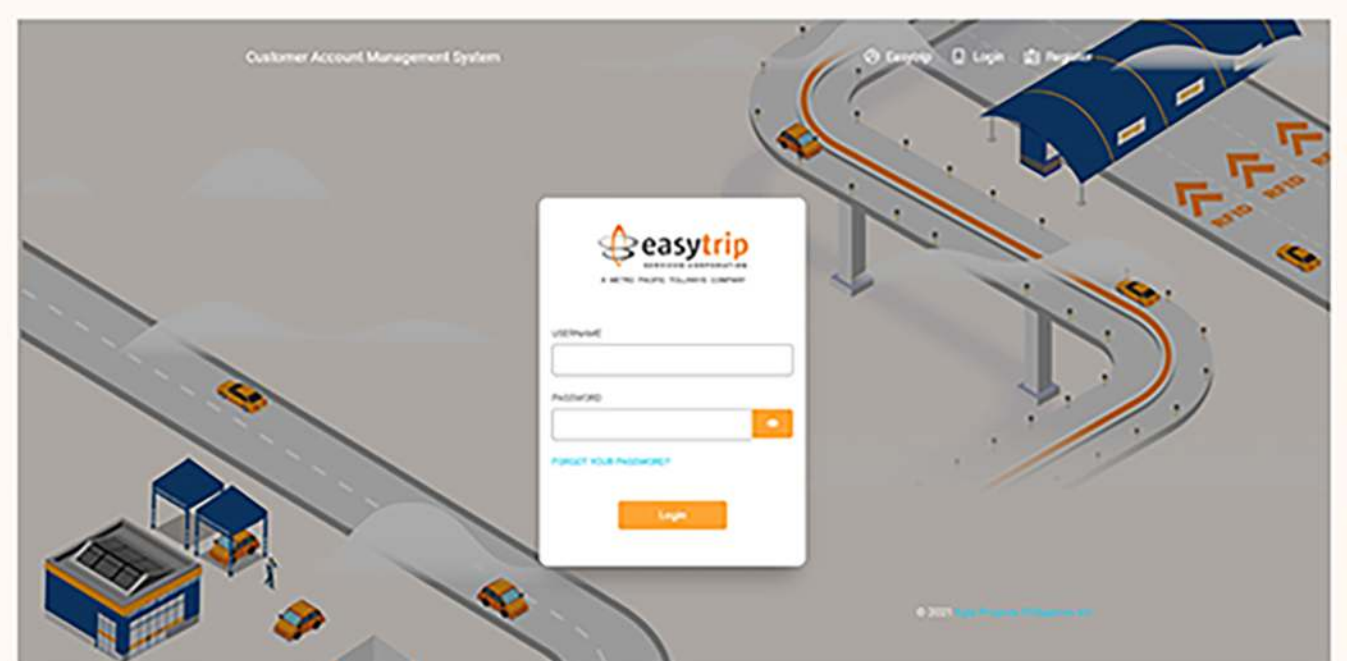

FORGOT PASSWORD?

- Click the "Forgot Your Password" link on the login page of **myeasytrip**.
- On the forgot password screen, you must provide your Username. The system will ask if you want to change password via Email or Security Question. Then click, "Submit" button.

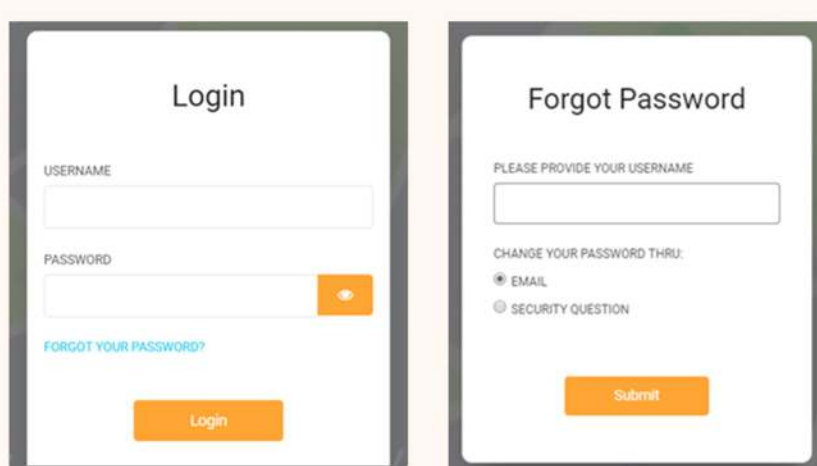

- Once you confirmed your password request via Email or Security Question was answered successfully. You will be redirected to "Reset Password" screen.
- Input the needed details and click the "Reset Password". Once successful, you can then login to your user account!

USER INTERFACE

